

## High production self-reversing tapping attachments with high-speed reverse and pre-selective torque control

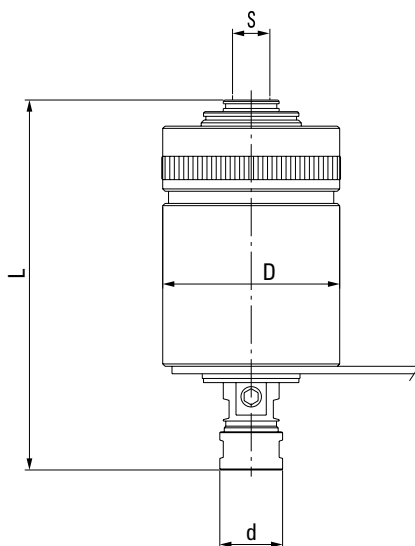

- for hard to machine material and high torque applications like roll form tapping
- less tap breakage due to pre-selective torque control
- reduced cycle time through increased 1.75:1 reverse speed
- easy handling, compact design
- easy adaptation with multiple interchangeable arbors

### How to Order

Please select the tapping attachment (A) and arbor (C) to fit your application. Choose an arbor to fit the thread or taper mount of the tapping attachment, with the Morse Taper, R8 or straight shank to fit your machine. Please order rubber flex collets and torque bars separately.

### Dimensions

(A) Model	D mm	d mm	Self-feed mm T	Weight kg
RX30	53	19	6	0.7
RX50	76	27	10	1.8
RX70	88	36	10	3.0

Model	Order code	Capacity (steel)	Collets Rubber Flex	Max. RPM	Mounts S		L
					Taper mounts	Thread. mounts	
RX 30	013006	M1.4-M7	21600	2000	JT6	3/8"-24 1/2"-20	116
	013016	#0 - 1/4"	21700		B16		
	013033				JT33		
	013037						
	013050						
RX 50	015006	M3-M12	22100	1500	JT6	1/2"-20	157
	015016	#6 - 1/2"	22200		B16		
	015033				JT33		
	015050						
RX 70	017003	M5-M18	24100	1200	JT3	7/8"-20	182
	017087	#10 - 3/4"	24500				

Note: When using Roll Form Taps the tool's tapping capacity must be reduced by 25 %.  
 Special thread mounts are also available to fit Burgmaster machines.  
 All dimensions are shown in mm. 25.4mm = 1"