

Tension/Compression tap chucks with modular straight shank and quick change

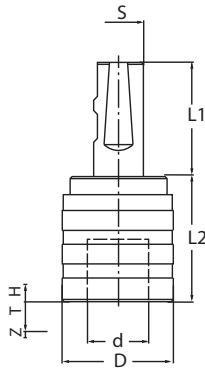

Dimensions

Model	D	d	L1	L2
TA0-016	29	13	48	38.0
TA0-020			50	
TA1-016	39	19	49	39.0
TA1-020			51	
TA1-025			57	
TA2-025	56	31	57	63.0
TA2-032				
TA3-032	81	48	61	124.0
TA4-040	99	60	71	135.5

TA tapping chuck with tension/compression. With its quick change spindle the taps can be changed in seconds.

Features and Advantages

- tension and compression
- releaseable hard start for consistent depth control
- front release protects against damage if over extended
- right hand and left hand tapping
- short projection

How to Order

Please order the tap chuck (A) and CAT, SK or BT shank (C) to fit your application. Please order tap adapters separately

(A) Model	Order code	Capacity (steel)	Shank	Adapter	Tension T	Compression H	Front release Z
TA0-016	490016	M1-M10	16 mm	Nr. 0	7.5	5	1.7
TA0-020	490020	#0 - 1/4"	20 mm	Nr. 0	7.5	5	1.7
TA1-016	491016	M3-M14	16 mm	Nr. 1	8	5	2.1
TA1-020	491020	#8 - 9/16"	20 mm	Nr. 1	8	5	2.1
TA1-025	491025		25 mm	Nr. 1	8	5	2.1
TA2-025	492025	M4.5-M24	25 mm	Nr. 2	15	8.5	2.8
TA2-032	492032	5/16" - 7/8"	32 mm	Nr. 2	15	8.5	2.8
TA3-032	493032	M14-M36, 13/16" - 1 3/8"	32 mm	Nr. 3	23.5	15	4.1
TA4-040	494040	M22-M48, 7/8" - 1 7/8"	40 mm	Nr. 4	25	16.5	5.7

Note: When using Roll Form Taps the chuck's tapping capacity must be reduced by 25 %.

Tension/Compression tap chucks with morse taper and quick change

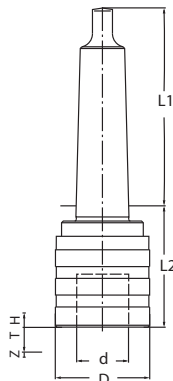

Dimensions

Model	D	d	L1	L2
TA0-MT1	29	13	62.0	43.5
TA0-MT2	29	13	75.0	45.0
TA1-MT2	39	19	75.0	47.0
TA2-MT3	56	31	94.0	71.0
TA3-MT4	81	48	117.5	105.0
TA4-MT5	99	60	149.5	116.5

How to Order

Please select the tap chuck (A) to fit your application. Please order quick change tap adapters separately.

(A) Model	Order code	Capacity (steel)	Morse taper MT	Tap adapters	Tension T	Compression H	Front release Z
TA0-MT1	490MT1	M1-M10	1	Nr. 0	7.5	5	1.7
TA0-MT2	490MT2	#0-1/4"	2				
TA1-MT2	491MT2	M3-M14	2	Nr. 1	8	5	2.1
TA1-MT3	491MT3	#8-9/16"	3				
TA2-MT3	492MT3	M4.5-M24	3	Nr. 2	15	8.5	2.8
TA2-MT4	492MT4	5/16"-7/8"	4				
TA2-MT5	492MT5		5				
TA3-MT4	493MT4	M14-M36	4	Nr. 3	23.5	15	4.1
TA3-MT5	493MT5	13/16"-1 3/8"	5				
TA4-MT5	494MT5	M22-M48	5	Nr. 4	25	16.5	5.7
TA4-MT6	494MT6	7/8"-1 7/8"	6				

Note: When using Roll Form Taps the chuck's tapping capacity must be reduced by 25 %. All dimensions are shown in mm. 25.4mm = 1"

